

C8 eLED PLUS™ Specifications

Lamp:	high-intensity white LED (x2)
Brightness:	170 lumen (high), 60 lumen (low) maximum
Input Voltage:	10.4 V (average)
Power:	10 watt (maximum)
Batteries:	alkaline C (x8), UK Nicad Pack, NiMH C (x8)
Burn Time:	10 hr (air), 4 hr (water) with alkaline c-cells
Beam Angle:	18° (air)
Test Depth:	500 feet
Seals:	Nitrile rubber o-ring seals
Catalyst:	Platinum on alumina pellets (4)
Polarization:	Light only operates with cells inserted properly
Switch:	Rotary FULL—OFF—HALF with push to lock safety
Materials:	ABS, polycarbonate, nylon, aluminum
Dimensions:	3.2 dia x 7.2 in
Weight:	39 oz with alkaline batteries in air

Typical
C8 eLED PLUS
Brightness in
Air and Water

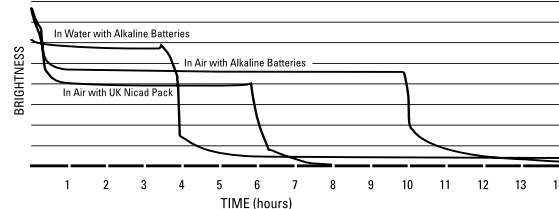

Care And Maintenance

- ✓ Keep area around the o-ring seal clean.
- ✓ If your light floods with water, turn it off immediately. After returning to shore or dive boat, unscrew the bezel and rinse the contents with fresh water. Allow all components to dry completely. Reassemble the light to see if it still works. If not, return it to your UK dealer or to UK International for repair. Remove the o-ring before shipping.
- ✓ If the reflector assembly should get wet, but still works after drying, be sure to have your dealer install a new hydrogen removal catalyst inside the reflector.
- ✓ Do not store batteries in the light for long periods of time. They may leak and damage the light.
- ✓ Do not attempt to remove or maintain the Conductive Cooling Element from the Bezel. Return it to UK for repair. Leakage may occur.

Limited Lifetime Warranty

UK International products are engineered for maximum performance and durability. All products carry a Limited Lifetime Warranty to the original retail purchaser to be free from defective material and workmanship under normal and intended use. In addition, the UK International Limited Warranty covers materials used in its products to the original purchaser, from the date of purchase, as follows: plastics for 10 years; fabrics and rubber for 3 years; rechargeable batteries for 90 days; and lamps for 30 days (batteries and lamps are not manufactured by UK International).

In the event the original retail purchaser detects a defect in the material or workmanship, the product along with proof of purchase date should be returned to an authorized UK International dealer or directly to UK International with the postage prepaid. UK International agrees to repair or replace at UK International's sole discretion any product found to be defective in material or workmanship within the time period specified above. For the complete Limited Lifetime Warranty write to UK International or check the website www.ukinternational.com. Address all correspondence and returns to:

UK International
13400 Danielson Street
Poway, CA 92064 U.S.A
Phone: (619) 513-9100
e-mail: info@ukinternational.com
web: ukinternational.com

© 2006 UK. All Rights Reserved.
"UNDERWATER KINETICS," the UK logo
and all product names and logos are
trademarks of Underwater Kinetics.

400191 Rev 6/9/06

UK C8 eLED PLUS™ Dive Light High-intensity Dive Light



INSTRUCTIONS

C8 eLED PLUS™ Operation

Thank you for purchasing the C8 eLED PLUS high intensity dive light. We have worked hard to create a light which is safe, reliable and able to help you see things you have perhaps never seen before.

The C8 eLED PLUS is designed to UK International's high standards for waterproof lights in safety and function. It starts with a unique dual power electronic circuit to control the matched pair of 5-watt white LEDs. Polarized battery contact plates make it possible to interchange individual battery cells and rechargeable packs as well as prevent potentially dangerous reverse battery insertion. The rubber lens guard, non-breakable locking switch and interchangeable handles are examples of diver hardened construction throughout. Last but not least, the C8 eLED PLUS is brightest in its class, perfect for piercing the darkness and looking into the great unknown.

Special Features

- High-intensity 10-watt twin LED module with proprietary conductive cooling element shines brighter underwater
- Unique optical design unites two high intensity LEDs into one beam with twice the intensity
- eLED circuitry insures constant brightness through out the battery life
- Switch between full and half power to extend battery life

Unpacking and Assembly

1 Install Heat Protector Cap Remove one of the heat protector caps from the small poly bag included with the light. Press it onto the aluminum conductive cooling element located in the center of the bezel as shown in the diagram on the right. It will snap into place. The cap provides protection to you if you should accidentally touch the conductive cooling element when the light is in use out of water. The conductive cooling element can become extremely hot after long periods of use.

2 Install Pistol or Lantern Grip Slide either the pistol or lantern grip which was included with the light into the dovetail groove as shown in the diagram on the right. Using a phillips screw driver to tighten the locking screw in handle just until the handle no longer slides in the groove. Overtightening the screw can damage the case. Undertightening the screw will allow the grip to slide out of the groove

3 Install Batteries Install the battery plate in the bottom of the case making sure that the springs point into the case and the plate is oriented as in the diagram at the right. Drop 8 alkaline, NiCad or NiMH C-size cells into the case observing the + and - polarity markings. **If batteries are inserted incorrectly the light will not function.**

4 Clean O-ring Remove the O-ring and clean it by running it between your fingers until it feels smooth. Wipe the areas around the case and bezel which touch the o-ring with a soft cloth until those areas are clean. Lightly grease the O-ring with silicone grease and place it at the base of the threads on the case.

5 Install Bezel / eLED Light Module The eLED Light Module contained in the Bezel should not be removed. **Removal of the eLED Light Module from the Bezel will void the UK warranty.** Place the bezel / eLED Light Module over the opening in the case with the slot in the white switch on the side of the reflector aligned with the switch on the case. While pressing the bezel into the case, twist it onto the case until the O-ring is compressed. Screw the bezel on approximately 1/4 turn past the point when the O-ring first contacts the bezel and begins to be compressed. Do not over tighten.

HIGH / OFF / LOW Power Switch

Pull out the lock in order to rotate the switch located near the grip between HIGH, OFF and LOW power. Push the lock inward to prevent accidental rotation.

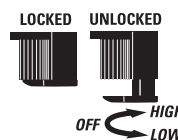

eLED Light Module

The 10-watt eLED light module contains a pair of high intensity white LEDs which are controlled by an electronic circuit which maintains constant brightness during the life of the batteries. The rotary switch selects whether the circuit delivers full power or partial power for increasing battery life. In order to deliver maximum brightness underwater a conductive cooling element transfers heat generated by the LEDs directly to the water through the front of the bezel. This feature is based on the fact that LEDs are more efficient and brighter when kept cool. A graph on the specifications page shows the results of the feature. The white color of the LED light penetrates water better than light from conventional incandescent lamps allowing greater visibility underwater.

Light Assembly

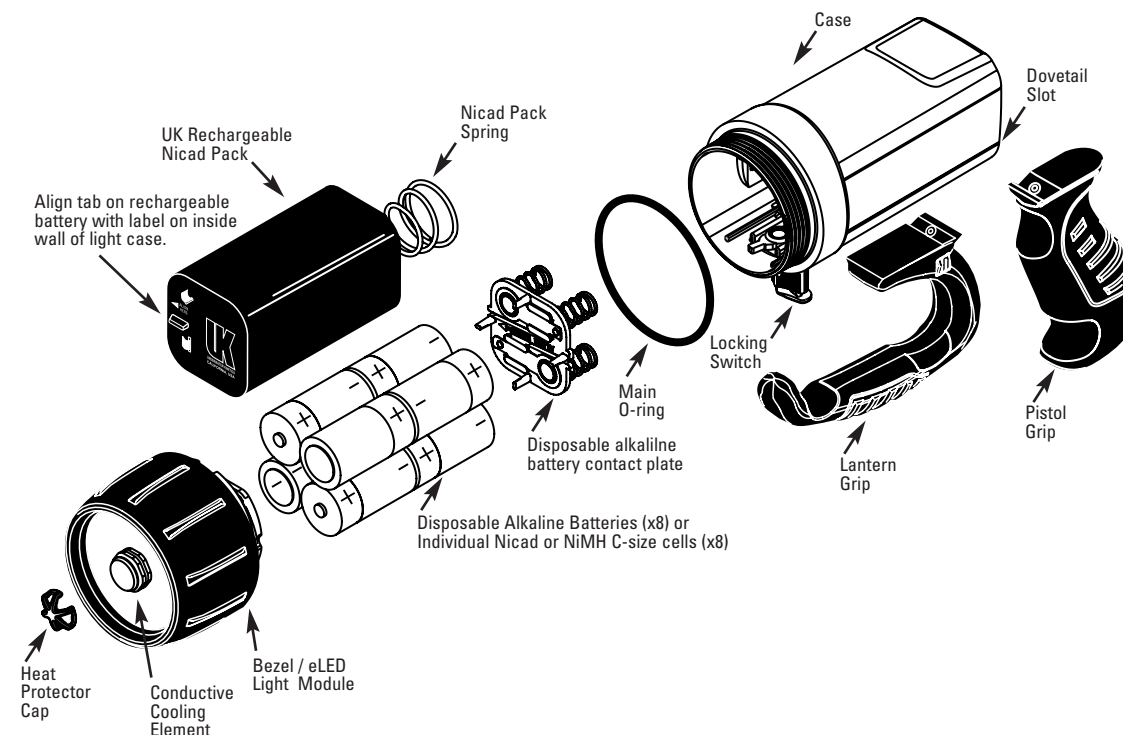

UK Nicad Battery Pack

The rechargeable battery pack is charged by inserting the charge plug from the charger in to the socket on the end of the battery pack. Charge the pack 10-12 hours or until the pack begins to feel warm. For maximum burn time charge the pack immediately before use. A battery stored for several months will need to be charged and discharged several times for maximum burn time to return.

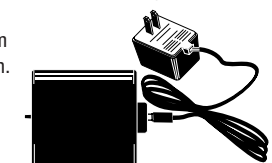

CAUTION

- Batteries which are (1) loaded without observing the proper polarity, (2) are not the same type, brand name and age or (3) are completely discharged can vent hydrogen gas and possibly cause an explosion.
- Load batteries according to the diagram shown on the light or in these instructions.
 - Do not mix batteries of different type, brand name or age.
 - Discard all batteries as soon as they are drained or no longer produce light.