

LIMITED LIFETIME WARRANTY

Underwater Kinetics products are engineered for maximum performance and durability. All products carry a Limited Lifetime Warranty to the original retail purchaser to be free from defective material and workmanship under normal and intended use. In addition, the Underwater Kinetics Limited Warranty covers materials used in its products to the original purchaser, from the date of purchase, as follows: plastics for 10 years; fabrics and rubber for 3 years; rechargeable batteries for 90 days; and lamps for 30 days (batteries and lamps are not manufactured by Underwater Kinetics).

In the event the original retail purchaser detects a defect in the material or workmanship, the product along with proof of purchase date should be returned to an authorized Underwater Kinetics dealer or directly to Underwater Kinetics with the postage prepaid. Underwater Kinetics agrees to repair or replace at Underwater Kinetics' sole discretion any product found to be defective in material or workmanship within the time period specified above. For the complete Limited Lifetime Warranty write to Underwater Kinetics.

Address all correspondence and returns to: Underwater Kinetics; 13400 Danielson Street; Poway, CA 92064 U.S.A.; email info@ukbright.com

LITFINGER SPECIFICATIONS

Lamp: 1-watt high intensity LED

Lamp Life: 50,000 hours

Maximum Brightness: 15 lumens (high); 7 lumens (low)

Burn Time: 4 hours (high); 10 hours (low)

Voltage: 3.6 volts

Battery: 3 x Alkaline AAA or Lithium AAA-cell

Materials: Aluminum body

Size: 5.7 x 4.8 x 0.8 inch

Weight: 6.8 oz with batteries

Arc Blast Test: Passed 3000 V, 8000 A, 0.5 sec (30 cycles)

PN 400118 rev 8/4/05

LITFINGER™ INSTRUCTIONS

Lights Up
Your Hot Stick For
Safety And
Efficiency



® Poway, California • www.ukbright.com

LITFINGER OPERATION

The LITFINGER™ is the first hot stick finger light. It has a built-in, unbreakable, LED light for use in dark or unlighted areas, making it safer and more efficient for night operations. The universal slotted mount is designed to fit all major brands of hot sticks.

Battery Insertion Open the battery compartment door by pulling back on the lid locking clip. Load 3 alkaline AAA cells as shown with the + positive ends of the batteries all pointing the same direction. For cold weather operation lithium AAA cells can be used. Make sure that the rubber gasket water seal around the lid is clean, then snap the lid closed.

OFF-HIGH-OFF-LOW Switch

Pushing the black switch toggles the light between high brightness and low brightness (longer burn-time) as shown in the graph.

Everytime the light is turned OFF and ON, the brightness is switched from HIGH to LOW or LOW to HIGH.

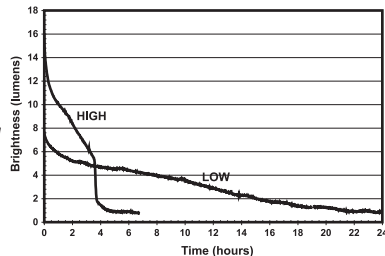

Hot Stick Attachment Bolt the LITFINGER™ to the end of a hot stick using the universal splined slotted connector.

Using the LITFINGER™ Turn the LITFINGER™ on HIGH or LOW power before raising the stick. A pointed head is provided for chipping off ice or debris from the work area. While lowering or raising the hot stick, a notch is provided in the straight arm to help prevent a fuse from dropping. The curved arm is provided for temporarily hanging the stick.

Maintenance Although the LITFINGER™ lid is sealed, make sure it is dry after use. If it becomes wet, shake or blow the water out and allow the unit to dry before resealing. Do not store batteries in the light during extended periods of storage. To save batteries, make sure the light is OFF after use.

LITFINGER™
Designed by Linemen for Linemen

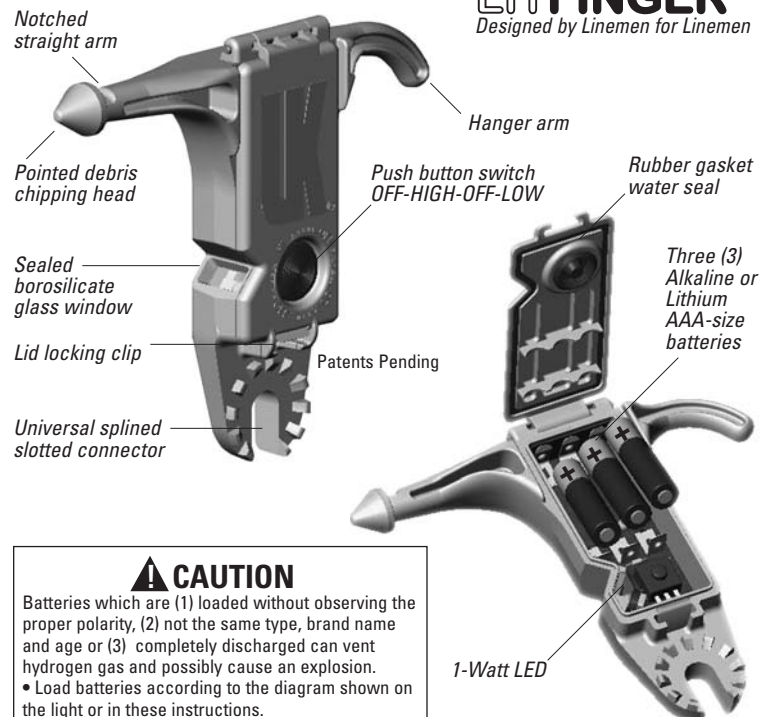

CAUTION

Batteries which are (1) loaded without observing the proper polarity, (2) not the same type, brand name and age or (3) completely discharged can vent hydrogen gas and possibly cause an explosion.

- Load batteries according to the diagram shown on the light or in these instructions.
- Do not mix batteries of different type, brand name or age.
- Discard all batteries as soon as they are drained or no longer produce light.

