



Thank you for purchasing this Underwater Kinetics light. We have worked hard to create a light which is safe, reliable and brightest in its class.

The AquaSun eLED Dive Light is designed for maximum performance underwater. To do this we take advantage of the fact that LEDs are most intense when kept cool. Two high intensity LEDs are attached to a heat sink which is in direct contact with the water through the front lens. This patented system cools the LEDs and allows them to burn almost twice as bright underwater. The white color of the LED light penetrates water better than light from conventional incandescent lamps allowing greater visibility underwater. In addition an electroic ciucuit monitors the LEDs and prevents overheating and allows the selection of full power or battery saving mode. A unique reflector combines the beams of 2 LEDs into a single beam which is twice as bright. Even though the LEDs are extremely efficient in power usage, they exceed the capacity of disposable alkaline batteries and must be powered by a rechargeable battery pack. The rubber lens guard and non-breakable locking switch are examples of diver hardened construction

Unpacking and Assembly

1 Install Heat Protector Cap Remove one of the heat protector caps from the small poly bag included with the light. Press it onto the aluminum conductive cooling element located in the center of the bezel as shown in the diagram on the right. It will snap into place. The cap provides protection to you if you should accidentally touch the conductive cooling element when the light is in use out of water. The conductive cooling element can become extremely hot if the light has been on for a long period of time.

2 Install Battery Pack Charge the battery pack for 12 hours before use. Insert the Nicad Pack as shown in the diagram. Be sure to align the battery tab with the mark inside the case.

3 Clean O-ring Remove the O-ring and clean it by running it between your fingers until it feels clean and smooth. Wipe the areas around the case and bezel which touch the o-ring with a soft cloth until those areas are clean. Lightly grease the O-ring with silicone grease and place the O-ring at the base of the threads on the case.

4 Install Bezel / eLED Light Module The eLED Light Module contained in the Bezel should not be removed. Removal of the eLED Light Module from the Bezel will void the UK warranty. Place the bezel / eLED Light Module over the opening in the case with the slot in the white switch on the side of the reflector aligned with the switch on the case. While pressing the bezel into the case, twist it onto the case until the O-ring is compressed. Screw the bezel on approximately 1/4 turn past the point when the O-ring first contacts the bezel and begins to be compressed. Do not over tighten.

5 Turn Light ON (high/low) Pull out the lock in order to rotate the switch which is located near the grip between HIGH, OFF and LOW power. Push the lock inward to prevent accidental rotation. When traveling always lock the switch in the OFF position.

Care and Maintenance

- Keep area around the o-ring seal clean.
- Do not allow the light to get hotter than 130°F (55°C) in order to prevent damage to batteries and sealing surfaces.
- If your light floods with water, turn it off immediately. After returning to shore or dive boat, unscrew the bezel and rinse the contents with fresh water. Allow all components to dry completely. Reassemble the light to see if it still works. If not, return it to your UK dealer or to UK International for repair. Remove the o-ring before shipping.
- If the reflector assembly should get wet, but still works after drying, be sure to have your dealer install a new hydrogen removal catalyst inside the reflector.
- Do not store batteries in the dive light for long periods of time. They may leak and damage the light.
- Do not attempt to remove or maintain the Conductive Cooling Element from the Bezel. Return it to UK for repair. Leakage

Limited Lifetime Warranty

Underwater Kinetics products are engineered for maximum performance and durability. All products carry a Limited Lifetime Warranty to the original retail purchaser to be free from defective material and workmanship under normal and intended use. In addition, the Underwater Kinetics Limited Warranty covers materials used in its products to the original purchaser, from the date of purchase, as follows: plastics for 10 years; fabrics and rubber for 3 years and lamps for 30 days.

In the event the original retail purchaser detects a defect in the material or workmanship, the product along with proof of purchase date should be returned to an authorized Underwater Kinetics dealer or directly to Underwater Kinetics with the postage prepaid. Underwater Kinetics agrees to repair or replace at Underwater Kinetics' sole discretion any product found to be defective in material or workmanship within the time period specified above. For the complete Limited Lifetime Warranty write to Underwater Kinetics or go to the website www.underwaterkinetics.com.

Address all correspondence and returns to:

Underwater Kinetics
13400 Danielson Street
Poway, CA 92064

AquaSun eLED Performance

Lamp:	19936 eLED Module
Type:	Paired high intensity white LEDs
Input V:	9.6 V (nom)
Brightness:	825 lumens (at 3 minutes), 6.2 watt (max)
Batteries:	8 nicad C
Burn Time:	2 hr (air and water)
Reflector:	medium penetrating beam
Depth:	Waterproof to 500 ft / 150 m
Seals:	Nitrile rubber o-ring seals
Catalyst:	Platinum on alumina pellets (4)
Polarization:	Light only operates with cells inserted properly
Switch:	Rotary FULL—OFF—HALF with push to lock safety
Materials:	ABS, polycarbonate, polypropylene, nylon
Dimensions:	ø 3.2 x 7.2 in / ø 8.1 x 18.3 cm
Weight:	40 oz / 1.13 kg (in air)

AquaSun eLED Brightness in Air and Water

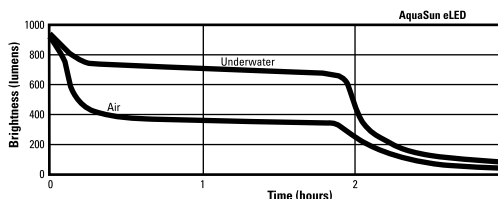

AquaSun eLED Assembly

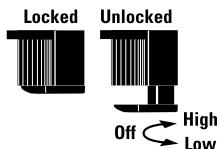
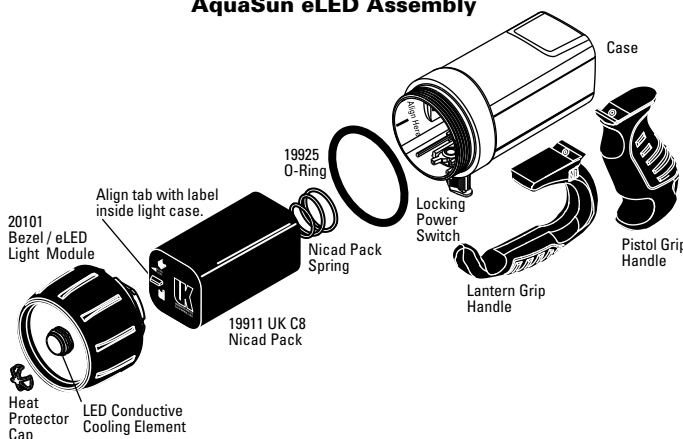

Nicad Battery Pack Charging

Charge the Nicad Battery Pack by inserting the charge plug from the charger into the socket on the end of the battery pack. Charge the pack 10-12 hours or until the pack begins to feel warm. For maximum burn time charge the pack immediately before use. A battery stored for several months will need to be charged and discharged several times for maximum burn time to return.

